



CASPER VEIN Compilation map

(back pack drilling, channel sampling, chip sampling)

New Discovery!
Casper vein contains **high grade gold** with silver, copper and lead less than 1000 metres from access road
144 g/t Au in chip sample
17.15 g/t Au over 0.85 m channel sample
64.6 g/t Au over 0.6m back pack drill core
Soil and MMI surveys indicate the mineralized system has a strike length of at least 500 metres and remains open

Casper Backpack Drill Holes					
BPH	From - To (m)	Au g/t	Ag g/t	Cu %	Pb %
1	0 - 0.6	25.00	90.50	1.10	1.42
	0.6 - 1.2	12.60	47.50	0.72	0.43
2	0 - 0.6	0.39	44.00	1.19	0.59
	0.6 - 1.2	0.02	0.10	0.01	0.00
3	0 - 0.6	10.90	24.90	0.33	0.14
	0.6 - 1.2	0.02	0.10	0.01	0.00
4	0 - 0.6	17.60	46.70	0.16	1.24
	0.6 - 0.8	3.02	18.60	0.44	0.33
5	0 - 0.6	4.72	133.00	0.27	3.56
	0.6 - 1.2	13.10	84.90	0.29	2.29
6	0 - 0.2	0.02	4.90	0.14	0.02
7	0.6 - 1.2	14.30	16.30	0.23	0.15
8	0 - 0.6	37.50	44.70	0.10	0.93
9	0 - 0.8	49.60	89.90	0.61	3.95
10	0 - 0.6	0.13	1.40	0.03	0.02
	0.6 - 1.0	0.39	1.70	0.04	0.01
11	0 - 0.6	0.76	2.90	0.10	0.01
	0.6 - 1.1	5.36	24.80	0.35	0.51
12	0 - 1.2	7.16	42.50	0.54	0.65
13	0 - 1.5	0.04	0.30	0.02	0.01
14	0 - 1.0	0.59	0.60	0.02	0.00
15	0 - 1.7	0.01	0.30	0.02	0.00
	1.7 - 2.5	0.72	1.30	0.05	0.01
16	0 - 1.3	0.36	1.20	0.02	0.03
17	-	-	-	-	-
18	0 - 0.5	24.30	50.40	0.81	2.78
19	0.7 - 1.2	4.60	6.20	0.04	0.03
20	0 - 0.6	64.60	78.10	0.41	0.40
21	0 - 0.6	1.02	11.80	0.03	0.10

vein exposed by hand trenching more than 45 metres
remains open

up to 144 g/t Au!

LEGEND

- ⊗ x g/t Au Backpack Drill Hole
- ▬ x g/t Au Channel Sample
- Rock Sample**
 - 0 - 0.5 g/t Au
 - 0.5 - 1.0 g/t Au
 - 1.0 - 10.0 g/t Au
 - > 10.00 g/t Au

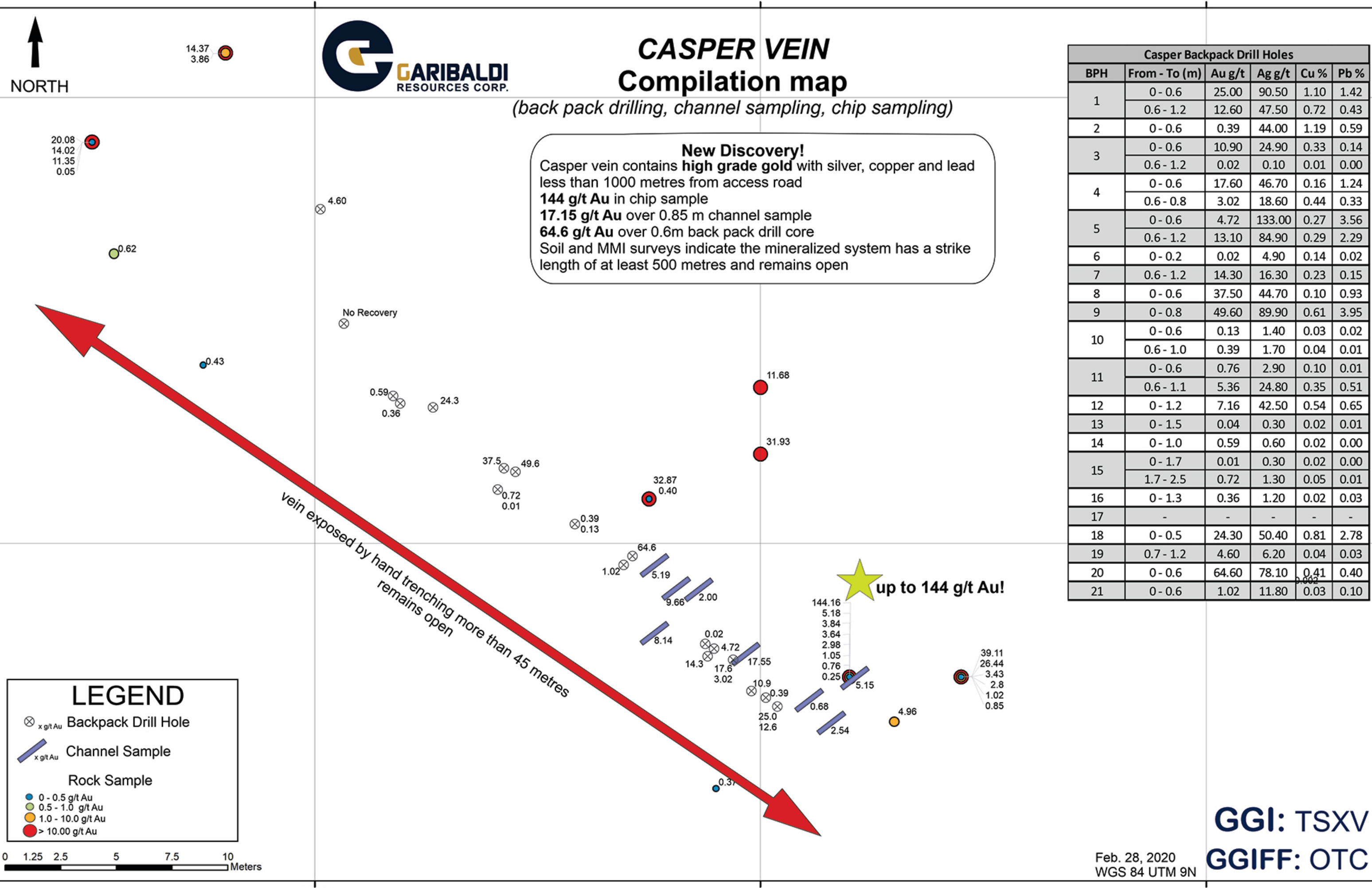
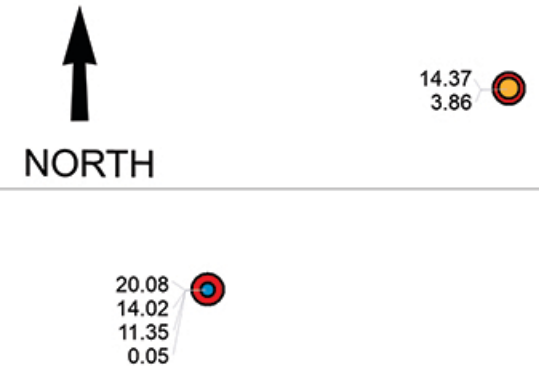

Feb. 28, 2020
WGS 84 UTM 9N

GGI: TSXV
GGIFF: OTC